

Architectural Inventory Form

Official Eligibility Determination (for OAHF use only)

- Date _____ Initials _____
- Determined Eligible - National Register
 - Determined Not Eligible - National Register
 - Determined Eligible - State Register
 - Determined Not Eligible - State Register
 - Need Data
 - Contributes to eligible National Register District
 - Noncontributing to eligible NR District

I. Identification

1. Resource number: 5HN68.68
2. Temporary resource number: 19
3. County: Hinsdale
4. City: Lake City
5. Historic building name: Gerbert-Wheeler House
6. Current building name:
7. Building address: 316 Bluff Street, Lake City, CO 81235
8. Owner name and address: Sorrell Top, L.L.C, P.O. Box 665 , Lake City CO 81235

II. Geographic Information

- County Property No.: R1021
9. P.M. 6th Township 44N Range 4W SE4 of NW4 of SW4 of Section 27
 10. UTM reference
Zone 13 296630 mE 4211450 mN
 11. USGS quad name: Lake City Quad year: 1985 Map scale: X 7.5' ___ 15'
 12. Block(s): 56 Lot(s): 25-26 Legal:
Addition: Year of Addition:
 13. Boundary description and justification: Perimeter of parcel

III. Architectural Description

14. Building plan: Rectangular
15. Dimenons: 800 square feet
16. Number of stories: 1
17. External wall material(s): Wood horizontal siding, hardboard
18. Roof configuration: Front gabled
19. Roof material: Metal
20. Special features: Porch
21. General architectural description:
One-story, front-gabled log dwelling with corrugated metal roof. Facade clad in clapboards; walls of north and south elevation clad in hardboard. Façade windows are 2-over-2 double hungs. Off-center gabled entry porch has turned posts; shelters entrance with a paneled door and screen door. Shed-roofed section on north elevation has small square multi-pane windows. East elevation is clad in horizontal siding, has newer 4-over-4 windows and a newer glazed and paneled door accessed by a wood deck. Foundation covered in vertical board.
22. Architectural style/Building type: No style
23. Landscaping or special setting:

24. Associated building, features or objects:

Stable, garage, circa 1960

One-story, front-gabled frame building with metal roof with exposed eaves. Walls clad in painted metal sections. Two openings on north have swing-up garage doors.

Shed, circa 1920

Shed-roofed frame building with metal roof. Board door and 4-lite window in west elevation. Shed-roofed section on east.

IV. Architectural History

25. Date of construction Estimate: _____ Actual: 1877 Source of info: Hinsdale County Tax Rolls

26. Architect: None Source of info:

27. Builder/contractor: Unknown Source of info:

28. Original owner: James Gebert Source of info: Hinsdale County Tax Rolls

29. Construction history (major additions, alterations, demolitions):

Shed roofed addition built circa 1877, immediately after construction of log portion. Source: T. E. Barnhouse photograph, 1877. Addition built on rear, 1996.

30. Original location: Moved Date of move(s) _____

V. Historical Associations

31. Original use(s): Single dwelling

32. Intermediate use(s):

33. Current use(s): Single dwelling

34. Site type(s):

35. Historical background:

This small front-gabled house with shed roof addition to the north started out as a squared-log cabin. It was enlarged with the north addition and covered in clapboards at an early date, together with a long, narrow boardwalk leading to an alley privy, no longer extant, all of which is visible in an 1877 overview photograph of Lake City.

Tax record research of the property indicates it was owned by a variety of owners in the 19th Century, including John S. Hough who may have used it for investment property or perhaps employee housing for one of his local enterprises. The original owner of the house was James Gebert, who located the Hidden Treasure Mine and was a partner in the pioneer sawmill firm Gebert & Hall. Gebert was assessed taxes for ownership of the house in 1879.

Twentieth-century owners of Gebert-Wheeler were Thomas Halpin, a well known prospector who, among other mines, worked the famous Golden Fleece Mine at Lake San Cristobal, pioneer freighters Frank Wheeler and Clint Buskirk, and, up to 1995, Ed and Mildred Cromwell. It is now a rental property owned by the local business consortium Sorrel Top, LLC. A rear addition for additional bedroom and bath as completed in 1996; back buildings include a metal two-door garage building, dating from the 1960s, and several contiguous wooden storage sheds dating to the early 20th century.

36. Sources of information: Hinsdale County Tax Rolls, 1877-1939; T.E. Barnhouse photograph overview of Lake City, fall 1877; Sanborn Insurance Map of Lake City, August, 1886; Lake City TIMES, July 5, 1900, page 3, and October 25, 1906, page 3.

VI. Significance

37. Local landmark: Yes No Date of design.: _____ Design. authority: _____

Within Lake City Historic District (local historic district)

38. Applicable National Register Criteria:

- A. Associated with events that have made a significant contribution to the broad pattern of our history;
- B. Associated with the lives of persons significant in our past;
- C. Embodies the distinctive characteristics of a type, period, or method of construction, or represents the work of a master, or that possesses high artistic values, or represents a significant and distinguishable entity whose components may lack individual distinction; or
- D. Has yielded, or may be likely to yield, information important in history or prehistory
- Qualifies under Criteria Considerations A through G
- Does not meet any of the above National Register criteria

39. Area(s) of significance: Social history, architecture

40. Period of significance: 1877 -1904

41. Level of significance: National State Local

42. Statement of significance:

This dwelling reflects settlement and development of Lake City during the late 1800s mining era. It is also a good example of the vernacular dwellings built in town, as reflected by its lack of ornamentation that represents a particular style.

43. Assessment of historic physical integrity to significance:

The architectural integrity of this dwelling is intact, as evidenced by minimal alterations to its character-defining features.

VII. National Register Eligibility Assessment

44. National Register eligibility field assessment: Eligible Not Eligible Need Data

45. Is there National Register district potential? Yes No

Discuss _____

If there is National Register district potential, is this building Contributing Noncontributing

46. If the building is in an existing National Register district is it? Contributing Noncontributing
(Lake City National Historic District)

VIII. Recording Information

47. Photograph numbers: Roll 2, frames 20-22; Roll 3, frames 1A, 2A Negatives filed at: Lake City Town Hall

48. Report title: 2003 Architectural Survey of Lake City, Colorado

49. Date(s): September 2002 - June 2003

50. Recordors Cathleen M. Norman and Grant E. Houston

51. Organization: Town of Lake City

52. Address: 230 Bluff Street, Lake City CO 81235

53. Phone no. (970) 944-2333

Colorado Historical Society - Office of Archaeology and Historic Preservation
1300 Broadway, Denver CO 80203 (303) 866-3395

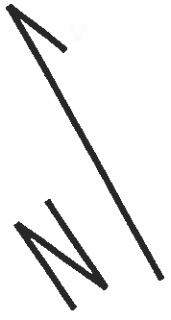

CASCO ADDITION

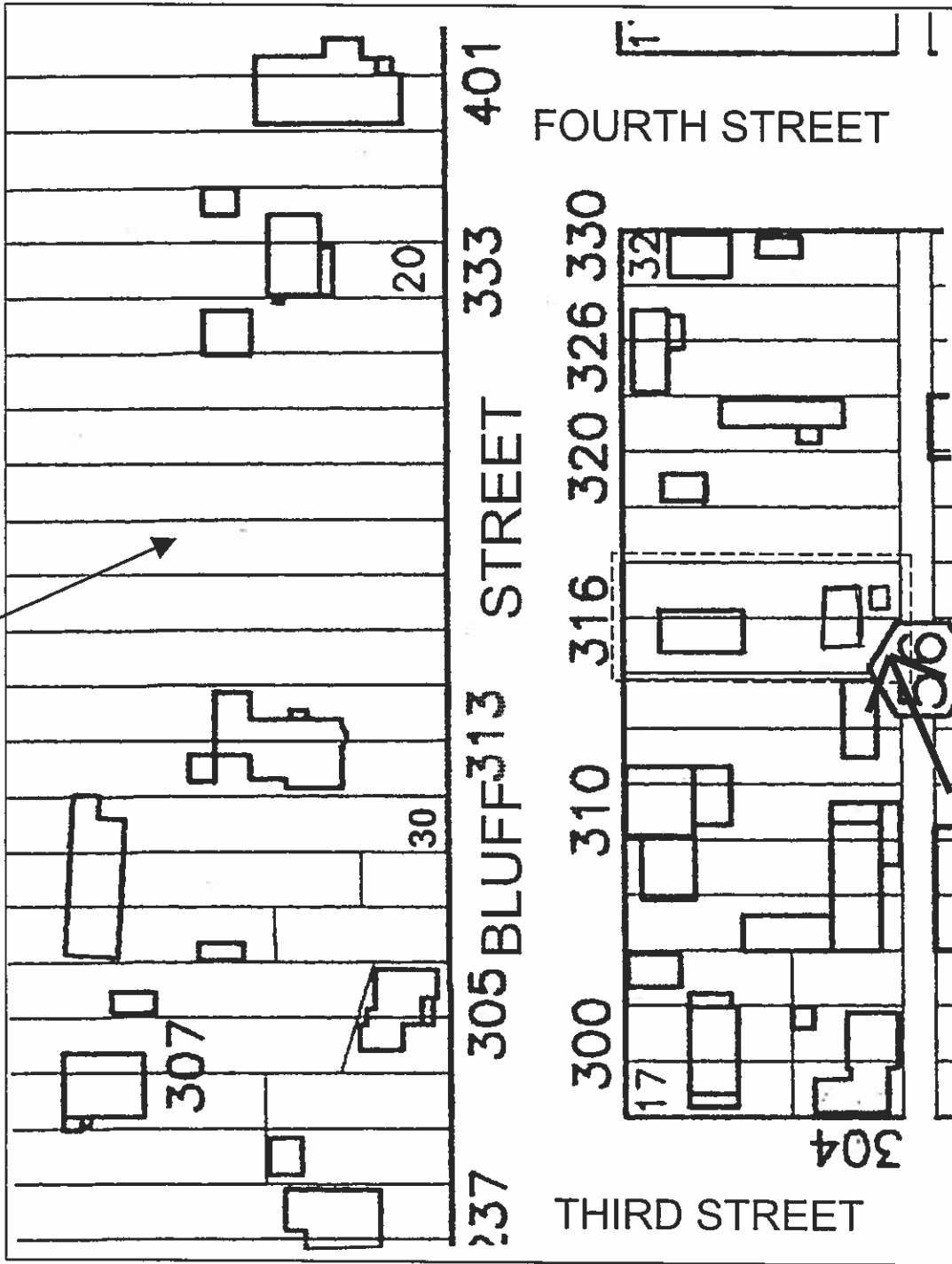
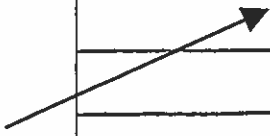

NOT TO SCALE