

Architectural Inventory Form

Official Eligibility Determination
(for OAHP use only)

- Date _____ Initials _____
- Determined Eligible - National Register
 - Determined Not Eligible - National Register
 - Determined Eligible - State Register
 - Determined Not Eligible - State Register
 - Need Data
 - Contributes to eligible National Register District
 - Noncontributing to eligible NR District

I. Identification

1. Resource number: 5HN68.63
2. Temporary resource number: 14
3. County: Hinsdale
4. City: Lake City
5. Historic building name: Hughes-Bell Cabin
6. Current building name: Hinsdale County Human Services Office
7. Building address: 304 Third Street, Lake City, CO 81235
8. Owner name and address: Hinsdale County - Board of County Commissioners, P.O. Box 277 , Lake City CO 81235

II. Geographic Information

County Property No.: R908T

9. P.M. 6th Township 44N Range 4W SE4 of NW4 of SW4 of Section 27
10. UTM reference
Zone 13 296640 mE 4211390 mN
11. USGS quad name: Lake City Quad year: 1985 Map scale: X 7.5' 15'
- 12 Block(s): 56 Lot(s): 17-19 Legal: E 50' of 17-19, Bock 56
Addition: Year of Addition: 0
13. Boundary description and justification: Perimeter of parcel

III. Architectural Description

14. Building plan: Irregular
15. Dimensions: 1143 square feet
16. Number of stories: 1
17. External wall material(s): Log, wood siding
18. Roof configuration: Gabled
19. Roof material: Metal
20. Special features: Chimney
21. General architectural description:
One-story, gabled dwelling of log and frame. Metal roof; gable end of log section is covered in horizontal wood siding. Fireplace chimney on west elevation is concrete covered in stone facing. Original section is of squared log ; it contains an off-center entrance with newer paneled and glazed door. Gabled, frame additions on north and east are clad in horizontal wood siding. Shed-roofed addition on rear. Windows are newer multi-lite windows. Concrete foundation.
22. Architectural style/Building type: Pioneer log
23. Landscaping or special setting:

24. Associated building, features or objects:
Shed, circa 1975
One-story frame shed-roofed building clad in plywood with composition roofing.

IV. Architectural History

25. Date of construction Estimate: _____ Actual: 1876 Source of info: Hinsdale County Tax Rolls, 1876-1939.
26. Architect: None Source of info:
27. Builder/contractor: Citizens of Lake City Source of info: SILVER WORLD, May 13, 1876
28. Original owner: Davey and Kitty Hughes Source of info: SILVER WORLD, May 13, 1876
29. Construction history (major additions, alterations, demolitions):
The log cabin was expanded with a frame addition and clapboards were applied to the exterior, including the log section, circa 1880. Cross-gabled addition built on the west circa 1965. The dwelling underwent restoration in 1998, which removed clapboards that had been applied circa 1800. The fireplace chimney was added on the west elevation, circa 2000.
30. Original location: Moved Date of move(s) _____

V. Historical Associations

31. Original use(s): Cabin
32. Intermediate use(s): Business office, single dwelling
33. Current use(s): Business
34. Site type(s):
35. Historical background:

Lake City's first marriage occurred May 9, 1876, when Davey Hughes, a compositor on the SILVER WORLD newspaper, married Miss Kitty Eastman. Townspeople immediately pitched in to construct this log cabin as a wedding gift to the couple, located on Third Street on the eastern end of Lots 17 and 18, Block 56, owned by the bridegroom. The newlyweds lived in the cabin for only a few months before selling the property to C.L. Peyton, a founding member of the SILVER WORLD.

Peyton in turn sold the cabin to attorney John C. Bell in 1879; Bell covered the log cabin with clapboards, added an addition and opened it as his law office and residence. It served solely as his law office after he moved his family to the next door property, the Bell-Soderholm House, 300 Bluff, in 1882. Bell sold the cabin to local miner Bill Hardy in 1925 and it was acquired by E.W. Soderholm as a rental in 1939. Later owners of the home added an exterior layer of stucco to the cabin which, with the earlier clapboards, was removed in 2000 to reveal the original Hughes log cabin. The cabin, together with a frame addition to the west dating from the mid-1960s, is today used as offices for Hinsdale County Human Services.

36. Sources of information:
Hinsdale County Tax Rolls, 1876-1939; SILVER WORLD, May 13, 1876, January 8, 1999, page 5, page 3; SILVER WORLD & LAKE CITY TIMES, August 23, 1917, page 2; LAKE CITY TIMES, February 5, 1914, page 3.

VI. Significance

37. Local landmark: Yes No Date of design.: _____ Design. authority: _____
Within Lake City Historic District (local historic district)
38. Applicable National Register Criteria:
- A. Associated with events that have made a significant contribution to the broad pattern of our history;
- B. Associated with the lives of persons significant in our past;
- C. Embodies the distinctive characteristics of a type, period, or method of construction, or represents the work of a master, or that possesses high artistic values, or represents a significant and distinguishable entity whose components may lack individual distinction; or
- D. Has yielded, or may be likely to yield, information important in history or prehistory
- Qualifies under Criteria Considerations A through G
- Does not meet any of the above National Register criteria
39. Area(s) of significance: Social history, architecture
40. Period of significance: 1876-1904
41. Level of significance: National State Local
42. Statement of significance:
This dwelling reflects settlement and development of Lake City during the late 1800s mining era. The original portion of the building typifies the Pioneer Log buildings constructed during Lake City's late 1870s settlement period. Like many others it was covered in clapboards soon after original construction.
43. Assessment of historic physical integrity to significance:
Although somewhat altered by the circa 1965 frame addition, this dwelling retains its architectural integrity through the squared-log construction, original openings, and original roof form.

VII. National Register Eligibility Assessment

44. National Register eligibility field assessment: Eligible Not Eligible Need Data
45. Is there National Register district potential? Yes No
- Discuss _____
- If there is National Register district potential, is this building Contributing Noncontributing
46. If the building is in an existing National Register district is it? Contributing Noncontributing
(Lake City National Historic District)

VIII. Recording Information

47. Photograph numbers: Roll 3, frames 4A-7A Negatives filed at: Lake City Town Hall
48. Report title: 2003 Architectural Survey of Lake City, Colorado
49. Date(s): September 2002 - June 2003
50. Recordors Cathleen M. Norman and Grant E. Houston
51. Organization: Town of Lake City
52. Address: 230 Bluff Street, Lake City CO 81235 53. Phone no. (970) 944-2333

Colorado Historical Society - Office of Archaeology and Historic Preservation
1300 Broadway, Denver CO 80203 (303) 866-3395

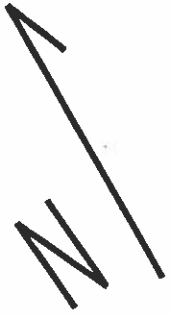

CASCO ADDITION

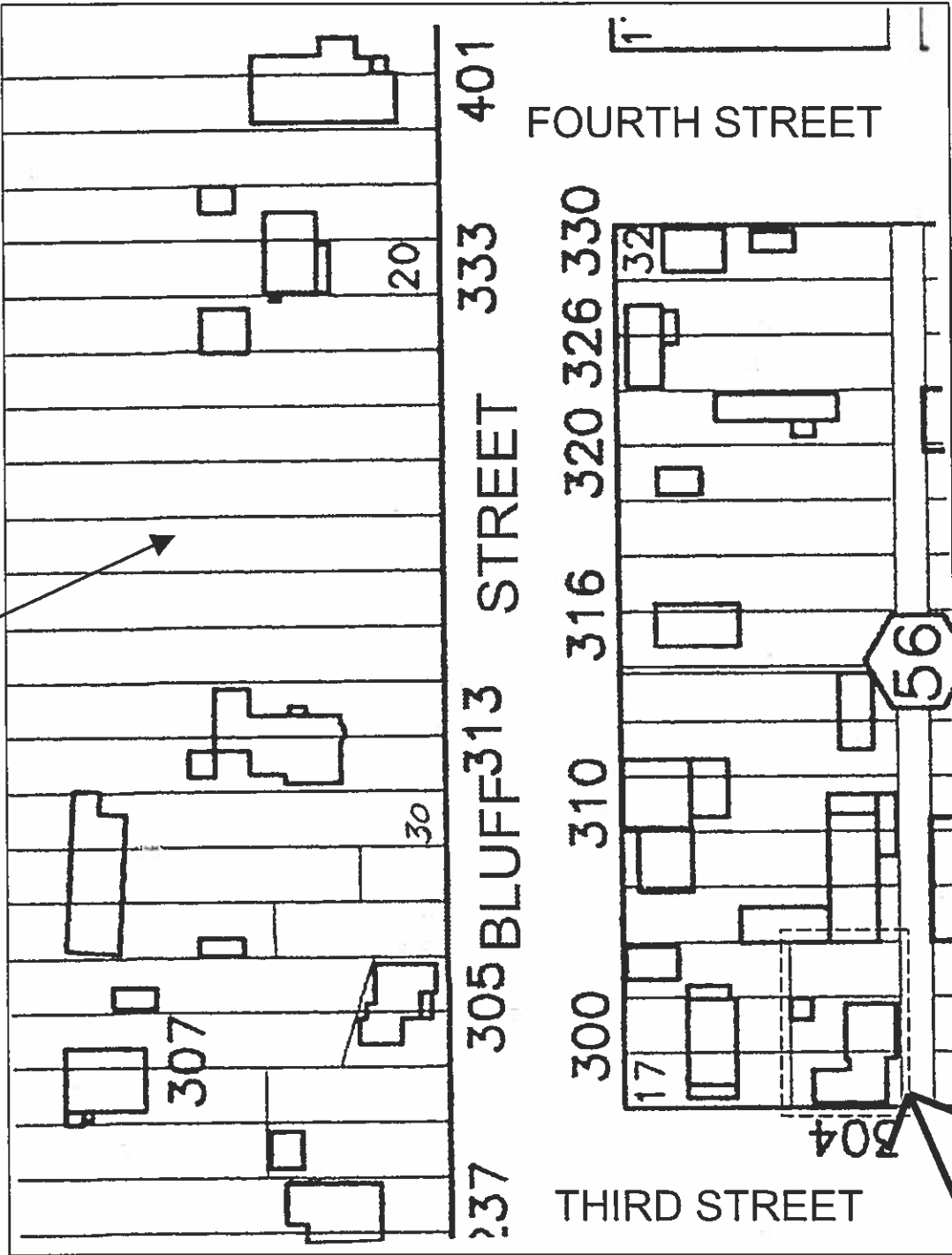
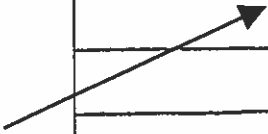

NOT TO SCALE