

Architectural Inventory Form

Official Eligibility Determination (for OAHP use only)

- Date _____ Initials _____
- Determined Eligible - National Register
 - Determined Not Eligible - National Register
 - Determined Eligible - State Register
 - Determined Not Eligible - State Register
 - Need Data
 - Contributes to eligible National Register District
 - Noncontributing to eligible NR District

I. Identification

1. Resource number: 5HN68.34
2. Temporary resource number: 13
3. County: Hinsdale
4. City: Lake City
5. Historic building name: Bell-Soderholm House
6. Current building name:
7. Building address: 300 Bluff Street, Lake City, CO 81235
8. Owner name and address: Mitchell Springs, Danny Belt, General Partner, P.O. Box 699, Cortez CO 81321

II. Geographic Information

County Property No.: R1122

9. P.M. 6th Township 44N Range 4W NE4 of NE4 of SW4 of Section 27
10. UTM reference
Zone 13 296610 mE 4211400 mN
11. USGS quad name: Lake City Quad year: 1985 Map scale: X 7.5' ___ 15'
12. Block(s): 56 Lot(s): 17-19 Legal: W 75' of 17-19, Block 56
Addition: Year of Addition: 0
13. Boundary description and justification: Perimeter of parcel

III. Architectural Description

14. Building plan: Rectangular
15. Dimensions: 1166 square feet
16. Number of stories: 1-1/2
17. External wall material(s): Wood
18. Roof configuration: Side gabled
19. Roof material: Composition
20. Special features: Chimney, porch, balcony, garage
21. General architectural description:

1-1/2 story side-gabled dwelling. Composition roofing, with brick chimney in roof ridge. Gable ends have friezeboard and decorative trim in gable apex. Walls are clad in clapboards. Façade has a large centered gable and a full-width balcony-porch. Porch has chamfered posts with decorative brackets; porch and balcony have turned balusters. Windows are 2-over-2 double hungs with pediment window heads and functional shutters.

Façade has centered entrances in first and second story; each has a paneled and glazed door with paired, arched lites (obscured by shutters in photograph), transoms, and functional shutters. Long, one-story, cross-gabled addition and shallow shed-roofed addition on rear have small multi-paned windows with shutters.

22. Architectural style/Building type: Late Victorian

23. Landscaping or special setting:

House is situated on a large, prominent, corner lot enclosed in a picket fence and metal gate.

24. Associated building, features or objects:

Garage, circa 1910

One-story, front-gabled frame building with corrugated metal roof; walls clad in shiplap siding. Swing-out doors and two-small square openings in gable façade. Small shed-roofed addition with walls clad in vertical and horizontal boards attached to south side of garage.

IV. Architectural History

25. Date of construction Estimate: _____ Actual: 1880 Source of info: Lake City MINING REGISTER, September 24, 1880

26. Architect: None Source of info:

27. Builder/contractor: Unknown Source of info:

28. Original owner: Unknown Source of info:

29. Construction history (major additions, alterations, demolitions):

The house was remodeled in 1882 by John Calhoun Bell. In 1912, the dwelling was moved and the one-story shed-roofed addition attached to rear of house. Source: Lake City TIMES June 13, 1912. A balcony was added to porch roof, balustrade added to porch and window in dormer converted to a door in the mid 1990s.

30. Original location: Moved Date of move(s) 1910

Moved 15 feet west on the same lot.

V. Historical Associations

31. Original use(s): Single dwelling

32. Intermediate use(s):

33. Current use(s): Single dwelling

34. Site type(s):

35. Historical background:

Prominent Colorado attorney John Calhoun Bell (1851-1933) is closely associated with this two-story frame residence, which he acquired and remodeled to its present appearance in 1882. Bell conducted a law office in Lake City from 1876 until 1885 and was prosecuting attorney in 1883 at the Lake City trial of Alferd Packer, accused of killing and cannibalizing five prospectors. Bell relocated to Montrose, Colorado, in 1885 and served successively as district court judge, five terms as Congressman from the Second District, and court of appeals judge.

As a rental, the house was residence of Lake City pharmacist Zeno Felder in the 1890s. Merchants Emil W. Soderholm (1874-1962) and Ida O'Brian Soderholm (1864-1955) bought the property in January, 1910, and a few months later had the house moved west from the alley toward the center of the corner lots. A long frame kitchen addition at the rear of the Bell-Soderholm House was originally located at the rear of the Soderholm's mercantile building, 223 Silver Street, but was moved and added to the Bluff Street residence in 1912.

In addition to living in the house, the Soderholms occasionally rented the house. One occupant was Lake City dentist Luther E. Shull who had his office in the front room of the house from 1917 to 1920. The Soderholms also owned several small houses in the neighborhood (including Hughes-Bell Cabin, next door) which they rented to tourists during the summer months.

Later owners of the Soderholm house were Edna Winblood and attorney Lynn French, prior to current owners Don and Barbara Belt who purchased it in 1991.

36. Sources of information:

Lake City MINING REGISTER, September 24, 1880, page 1, February 24, 1882, page 3, March 17, 1882, page 3; PROGRESSIVE MEN OF WESTERN COLORADO, A.W. Bowen & Co., Chicago, 1903, page 370; SILVER WORLD, August 17, 1933, page 2, March 29, 1996, page 12; Lake City TIMES, January 13, 1910, page 3, May 12, 1910, page 5, and June 13, 1912, page 3; Gunnison NEWS-CHAMPION, October 26, 1955, page 2, and January 25, 1962, page 5.

VI. Significance

37. Local landmark: Yes No Date of design.: _____ Design. authority: _____

Within Lake City Historic District (local historic district)

38. Applicable National Register Criteria:

- A. Associated with events that have made a significant contribution to the broad pattern of our history;
- B. Associated with the lives of persons significant in our past;
- C. Embodies the distinctive characteristics of a type, period, or method of construction, or represents the work of a master, or that possesses high artistic values, or represents a significant and distinguishable entity whose components may lack individual distinction; or
- D. Has yielded, or may be likely to yield, information important in history or prehistory
- Qualifies under Criteria Considerations A through G
- Does not meet any of the above National Register criteria

39. Area(s) of significance: Social history, architecture

40. Period of significance: 1880 -1904

41. Level of significance: National State Local

42. Statement of significance:

This house is associated with settlement and development of Lake City during the late 1800s mining era. It is representative of the modest version of Carpenter Gothic style constructed in Lake City during this period, as reflected in its steeply pitched roof, central gable, gable end ornamentation, and carved porch brackets. It borrows its triangular pediments from the Greek Revival style.

43. Assessment of historic physical integrity to significance:

The architectural integrity of this dwelling is intact, as evidenced by minimal alterations to its character-defining features.

VII. National Register Eligibility Assessment

44. National Register eligibility field assessment: Eligible Not Eligible Need Data

45. Is there National Register district potential? Yes No

Discuss _____

If there is National Register district potential, is this building Contributing Noncontributing

46. If the building is in an existing National Register district is it? Contributing Noncontributing
(Lake City National Historic District)

VIII. Recording Information

47. Photograph numbers: Roll 3, frame 8A-14A Negatives filed at: Lake City Town Hall

48. Report title: 2003 Architectural Survey of Lake City, Colorado

49. Date(s): September 2002 - June 2003

50. Recordors Cathleen M. Norman and Grant E. Houston

51. Organization: Town of Lake City

52. Address: 230 Bluff Street, Lake City CO 81235

53. Phone no. (970) 944-2333

Colorado Historical Society - Office of Archaeology and Historic Preservation
1300 Broadway, Denver CO 80203 (303) 866-3395



CASCO ADDITION

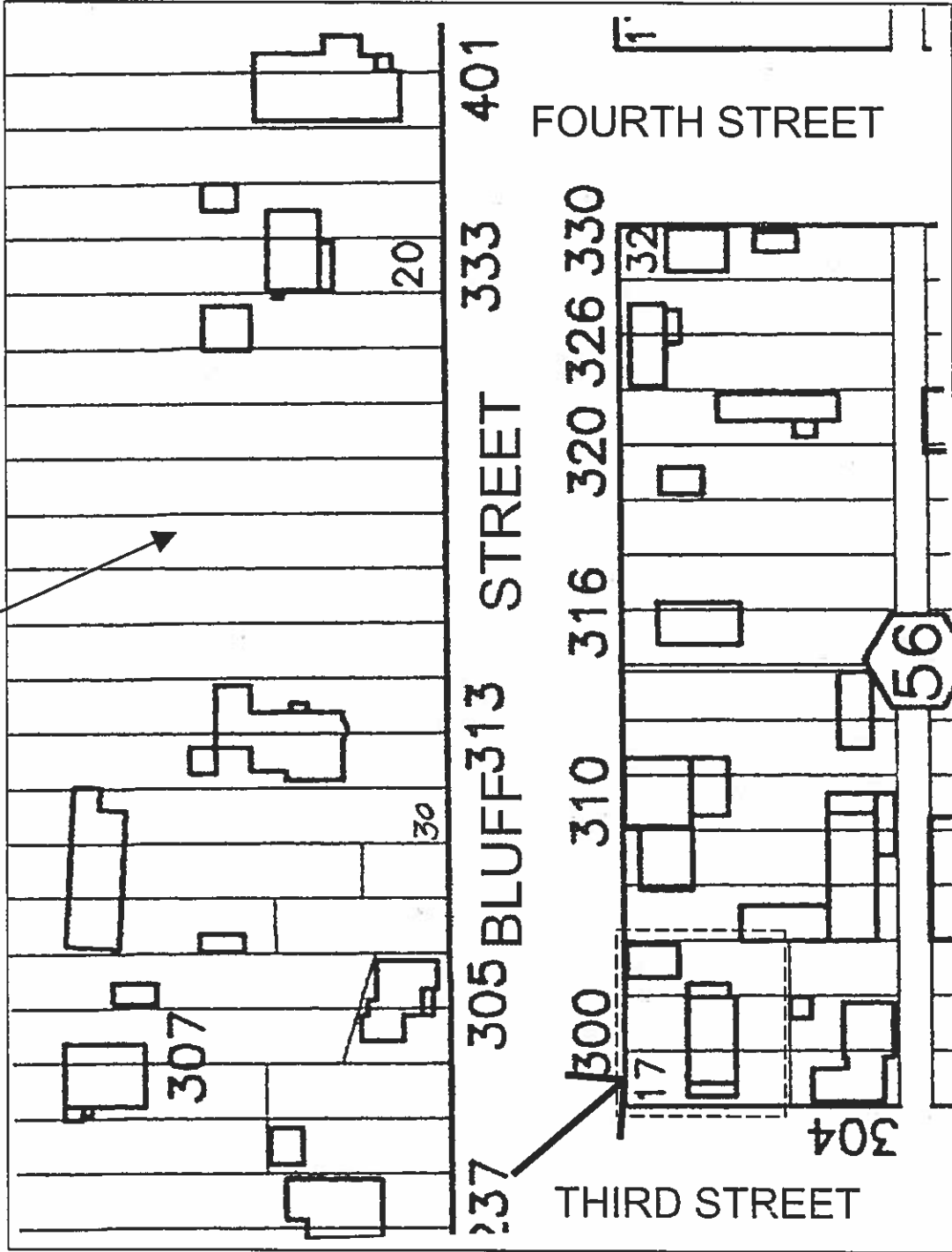
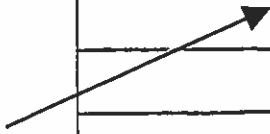

NOT TO SCALE